

AVer TabChargeCT2

40 Device Chromebook, Tablet, Laptop and Netbook Charge Cart

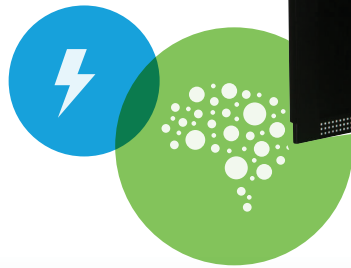

Load with ease

TabChargeCT2's two easy-access sliding shelves hold up to 40 laptops, Chromebooks, netbooks, iPads, Android and Windows tablets (devices with up to 14" screens).



We've got your back

With AVer, you not only get a superior solution, but you are backed by dedicated Technical and Customer Support teams, plus America's best cart warranty: 10 year mechanical/ 5 year electrical.



It's wise to organize

Rigid metal device separators and plastic guides are designed to fit and protect most mobile devices, allowing for easy routing of cables. Separate numbered compartments conveniently hold AC adapters.



Safe, secure, durable

With three-point steel locking mechanisms built into its cabinet doors, TabChargeCT2 provides a safe haven for your devices when they are being charged or stored.



Intelligent charging system

TabChargeCT2 monitors all 40 devices in groups of 10 and determines the best charging sequence: all device groups at once, or each group individually. No programming required – automatic, safe and efficient!



Dependable, versatile, maneuverable

TabChargeCT2's large capacity, steel construction, and smooth-rolling, 5" medical-grade locking swivel castors provide a rugged, yet easily maneuverable storage cart that can double as a teaching platform!

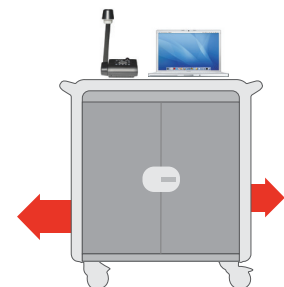

Specifications:

Device Capacity	40 (20 devices * 2 sliding shelves)
Slot Size (W x D x H)	W = 2.8cm (1.1") D = 36.4cm (14.33") H = 25.0cm (9.84")
Supported Devices	Chromebooks, iPads, Android, Windows Tablets, Netbooks (up to 14" screen, supports most tablet covers with total width up to 1.1")
Charging Type	Intelligent, self-monitoring, zone-based charging system; no programming required
External Power Outlets	4
LED Indicator	Power LED: Green Status LED (x4): Solid Blue: Regular Charging, Flashing Blue: Quick Charge
Cart Dimension	W = 97cm (38.19") D = 62cm (24.41") H = 103cm (40.43")
Package Dimension	W = 103cm (40.55") D = 72cm (28.35") H = 123.5cm (48.62")
Net Weight	87kg (191.8lbs)
Gross Weight	116kg (255.8lbs)

Power Specification	AC IN: 100-120V ~ 50/60Hz, 12A 220-240V ~ 50/60Hz, 8A PWR Strip 40-Port Total 100-120V ~ 50/60Hz, 8A 220-240V ~ 50/60Hz, 6A Outlet 4-Port Total 100-120V ~ 50/60Hz, 4A 220-240V ~ 50/60Hz, 2A
Cable Management	Numbered device slots with cable clips; individual AC adapter compartments
Security	Front and rear doors: 3 point mechanism with lock hole
Cooling/Ventilation	Ventilation slots along front/back panels
Push Cart Handles	Two: integrated, top/side mount
Casters	5" medical-grade casters (x4) 2 are lockable
Color	Exterior: Black doors, side panels White trim, auxiliary power panel Interior: Black doors, side panels Silver: Steel rod dividers AC adapter slots
Certification	UL certified
Warranty	10 years cart and tray 5 years electrical components
Accessories with Shipment	User manual, warranty card, power cord, cable clips

